

**KANEPACKAGE PHILIPPINE INC.**

No. 5 Ring Road LISP II, Brgy. La Mesa, Calamba City, Laguna
 Telephone No. (049) 5457-7166 to 69
 Fax No. (049) 545-6302

INVESTIGATION REPORT FORM (IRF)

Control No.:

Date Issued

0141

260204

Customer	BROTHER INDUSTRIES PHILIPPINES, INC.	Attention To	REXEL ALMARIO
Item Code	D038PE001	Department	PRODUCTION
Item Description	CARTON MFC-J1260W US/CAN-C	Date of Detection	260131
Job Order Number	JO26-M-00113-61A	Section Detected	QA SCREENING

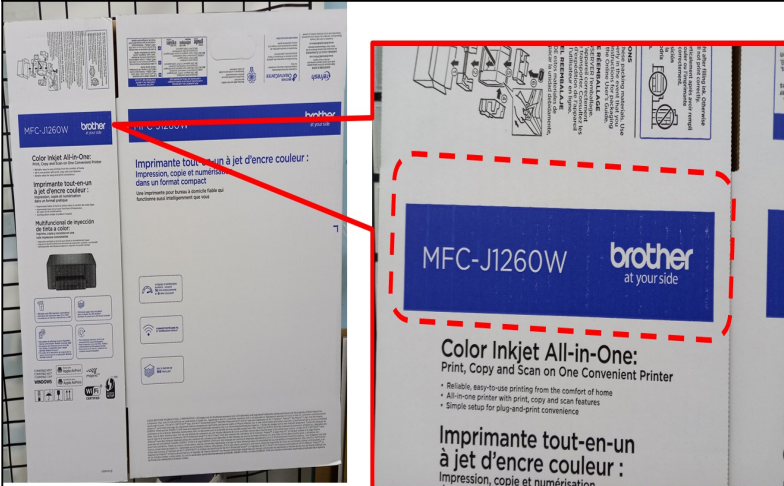
ILLUSTRATION OF THE PROBLEM

Lot Quantity (pcs)	Reject Qty (pcs)	Reject %
3400	110	3.24

Nature of Defect:

POOR PRINT

Requirement:

No poor print

Actual

With poor print

NO. OF OCCURENCE	DISPOSITION	AREA OF OCCURENCE / ORIGIN		CONTENT
<input checked="" type="checkbox"/> First <input type="checkbox"/> Recurrence No.: <u>1</u> Date.: <u>260131</u>	<input type="checkbox"/> Hold <input type="checkbox"/> Special Acceptance <input type="checkbox"/> For Rework <input checked="" type="checkbox"/> Reject / Disposal	<input type="checkbox"/> Slotter <input checked="" type="checkbox"/> EQOS <input type="checkbox"/> Diecut <input type="checkbox"/> Detaching	<input type="checkbox"/> Gluing <input type="checkbox"/> Vertical <input type="checkbox"/> Others	<input type="checkbox"/> Material <input type="checkbox"/> Dimension <input type="checkbox"/> Appearance <input checked="" type="checkbox"/> Process / Method
Issued by	Checked by	Approved by	Received by (Receiving Section)	
MA. ERIKA MAE ASIS 260204	CHARLENE JAN MARIE FLORES 260224	MICHAEL CASILLANO 260225	GERALD DE GUZMAN 260310	

I. INVESTIGATION / ANALYSIS**DIRECT CAUSE: (Analyze the reason of occurrence, why it happened?)****System / Training****Design / Toolings****Process / Material**

WHY 1 : uneven distribution of ink in the item

WHY 2 : insufficient pull nip pressure during operation

**KANEPACKAGE PHILIPPINE INC.**

No. 5 Ring Road LISP II, Brgy. La Mesa, Calamba City, Laguna
 Telephone No. (049) 5457-7166 to 69
 Fax No. (049) 545-6302

INVESTIGATION REPORT FORM (IRF)**INDIRECT CAUSE: (Analyze the reason of occurrence, why it leaked?)****System / Training****Design / Toolings****Process / Material**

WHY 1 : n/a

FINAL CONCLUSION**CORRECTIVE ACTION: (Actions to be done to ensure that the problem will not happen again)****WHO / WHEN****Process / Material**

WHY 1: Cascade to EQOS Operators the checking of machine set up prior mass pro and thorough checking of output during mass pro to ensure to eliminate or lessen such poor print

Production Leaders // 2026-04-27

IMMEDIATE ACTION: (Action to be done to contain/ temporary correct the problem found)**A. Sorting Result****C. Reworking**

	Location	Total Stock	NG	Total Good	Rework Quantity	00
RM	0	0	0	0	Total Good	0
WIP	0	0	0	0	Rework PPM (Good)	0
FG	0	0	0	0		

B. Orientation

Date	0001-01-01	Time	00:00
Title	0		
Attendees	0		

Prepared By:**Approved By:**

GERALD DE GUZMAN | 260423

REXEL ALMARIO | 260427

Department Head

**KANEPACKAGE PHILIPPINE INC.**

No. 5 Ring Road LISP II, Brgy. La Mesa, Calamba City, Laguna
 Telephone No. (049) 5457-7166 to 69
 Fax No. (049) 545-6302

INVESTIGATION REPORT FORM (IRF)**II. QA ROOTCAUSE VERIFICATION (To be filled out by QA In-charge)**

Date Conducted:	PIC:
Identified Rootcause	Recommendation

III. CORRECTIVE ACTION VERIFICATION (To be filled out by QA In-charge)

	Checked By:	Date	Implemented?	Running	JO Number	Date	NG Qty	Lot Qty
1st Verification of Action			[] Yes [] No	1st				
2nd Verification of Action			[] Yes [] No	2nd				
3rd Verification of Action			[] Yes [] No	3rd				
Effectiveness of Action			[] Yes [] No	4th				
Remarks:				5th				

IV. CLOSURE

Status	Remarks
Still Open	

Approved by:		Process Owner Acknowledgment: (Receiving Section)	
N/A	N/A	N/A	N/A
QA Head	Top Management	Line Leader	Department Head
Date: -	Date: -	Date: -	Date: -